



# FRONT-LOADING MULTI-LOAD COMMERCIAL WASHER (TOP DISPENSERS ONLY)

User's Guide

## TABLE OF CONTENTS

WASHER SAFETY .....	1
USING THE WASHER .....	2
SET-UP PROCEDURES .....	4
MAINTENANCE.....	4

## WASHER SAFETY

### Your safety and the safety of others are very important.

We have provided many important safety messages in this manual and on your appliance. Always read and obey all safety messages.



This is the safety alert symbol.

This symbol alerts you to potential hazards that can kill or hurt you and others.

All safety messages will follow the safety alert symbol and either the word "DANGER" or "WARNING." These words mean:

**! DANGER**

**You can be killed or seriously injured if you don't immediately follow instructions.**

**! WARNING**

**You can be killed or seriously injured if you don't follow instructions.**

All safety messages will tell you what the potential hazard is, tell you how to reduce the chance of injury, and tell you what can happen if the instructions are not followed.

State of California Proposition 65 Warnings:

WARNING: This product contains one or more chemicals known to the State of California to cause cancer.

WARNING: This product contains one or more chemicals known to the State of California to cause birth defects or other reproductive harm.

# WASHER SAFETY

## IMPORTANT SAFETY INSTRUCTIONS

**WARNING:** To reduce the risk of fire, electric shock, or injury to persons when using the washer, follow basic precautions, including the following:

- Read all instructions before using the washer.
- Do not wash articles that have been previously cleaned in, washed in, soaked in, or spotted with gasoline, dry-cleaning solvents, other flammable, or explosive substances as they give off vapors that could ignite or explode.
- Do not add gasoline, dry-cleaning solvents, or other flammable, or explosive substances to the wash water. These substances give off vapors that could ignite or explode.
- Under certain conditions, hydrogen gas may be produced in a hot water system that has not been used for 2 weeks or more. **HYDROGEN GAS IS EXPLOSIVE.** If the hot water system has not been used for such a period, before using the washing machine, turn on all hot water faucets and let the water flow from each for several minutes. This will release any accumulated hydrogen gas. As the gas is flammable, do not smoke or use an open flame during this time.
- Do not allow children to play on or in the washer. Close supervision of children is necessary when the washer is used near children.
- Before the washer is removed from service or discarded, remove the door or lid.
- Do not reach into the washer if the drum, tub or agitator is moving.
- Do not install or store the washer where it will be exposed to the weather.
- Do not tamper with controls.
- Do not repair or replace any part of the washer or attempt any servicing unless specifically recommended in this manual or in published user-repair instructions that you understand and have the skills to carry out.
- See “Electrical Requirements” located in the installation instructions for grounding instructions.

**SAVE THESE INSTRUCTIONS**

## USING THE WASHER

**⚠ WARNING**



**Fire Hazard**

**Never place items in the washer that are dampened with gasoline or other flammable fluids.**

**No washer can completely remove oil.**

**Do not dry anything that has ever had any type of oil on it (including cooking oils).**

**Doing so can result in death, explosion, or fire.**

### 1. Before Washing

Sort garments according to the clothing manufacturer’s recommendations. To avoid damage to the garments and washer, make sure that there are not any foreign objects such as nails, screws, needles, etc., in the load. Turn sleeves of shirts, blouses, etc. inside out. For best results, unfold garments and mix large and small pieces together.

### 2. To Open the Door

Open the door by pulling on the door handle or turning the door handle and pulling.

### 3. Loading the Washer

The washer has six (6) cycles on PD models and 15 preprogrammed cycles with the option to create up to

99 cycles on PN models. Proper wash cycle and wash temperature should be selected based on the type of load. For best results, do not overload the washer.

### 4. To Close the Door

Use the door handle to close the door, making sure the door is properly latched before placing the washer into operation.

### 5. Program Selections

**PD Models:**

The program can be chosen by pressing one of the 6 buttons on PD models. Choose the correct cycle depending on the type of fabric and desired wash temperature. These buttons are located on right hand side of the display.

1. WHITES..... HOT
2. COLORS..... WARM
3. BRIGHT COLORS..... COLD
4. PERMANENT PRESS..... WARM
5. QUICK WASH..... WARM
6. DELICATES AND KNITS..... WARM

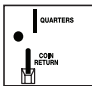

QUARTERS  
DOWN  
RETURN



**MAYTAG**  
COMMERCIAL WASHER  
BX

TO LOAD WASHER  
1. OPEN DOOR BY PULLING HANDLE.  
2. LOAD ITEMS.  
3. CLOSE DOOR (REQUIRED LATCHED HANDLE).

TO PRE-PROGRAMME  
1. PRESS WASH TEMP. TO SET DESIRED WASH TEMP. AT START OF CYCLE.  
2. PRESS WASH TEMP. TO SET DESIRED WASH TEMP. AT START OF CYCLE.  
3. PRESS WASH TEMP. TO SET DESIRED WASH TEMP. AT START OF CYCLE.

TO LOAD WASHERS  
1. PRESS WASH TEMP. TO SELECT CYCLE.  
2. PRESS WASH TEMP. TO SELECT CYCLE.  
3. WASHERS WILL START AUTOMATICALLY.



On all push button controls, one selection selects the proper wash and rinse temperatures for whites, colors, bright colors, permanent press, quick wash or delicates.

**NOTE:** All rinses are in cold water.

An indication on the display shows what stage the cycle is in at all times.

### PN models:

PN models have 15 factory set programs that can be selected by pressing the required program number. See program manual for proper factory-set cycle descriptions, selection, and possibilities.

For PD and PN models, see “Programming Manual” for instructions on modifying factory settings as well as available programming and setup options.

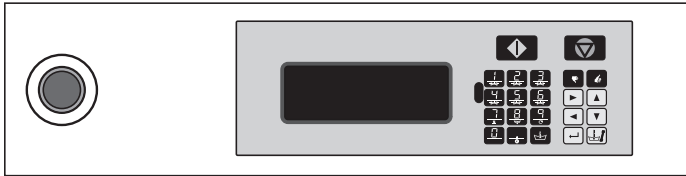

## 6. To Fill the Dispensers

The dispensers are located on the top, front, or side of the washer.

### Dispenser “A”

**Prewash** – It is recommended you add detergent for the prewash prior to starting the cycle.

### Dispenser “B”

**Main Wash** – Add powdered detergent or powdered bleach detergent prior to starting the cycle. You may add liquid detergent or liquid bleach during the “wash” cycle. If added at the start of the cycle, it will run into the washer prematurely.

### Dispenser “C” (top dispenser)

**Fabric Softener** – Add fabric softener prior to starting the cycle or before the final rinse.

### Dispenser “D” (front or side dispenser)

**Fabric Softener** – Add fabric softener prior to starting the cycle or before the final rinse.

**NOTE:** Use only High Efficiency (HE) detergents.

Top Dispenser

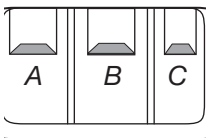

Front or Side Dispenser

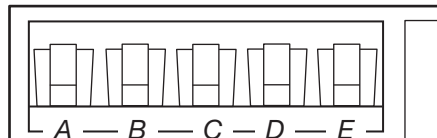

- Refer to the detergent manufacturer’s instructions for proper dosing. Too much detergent can cause poor wash results and excess sudsing.
- Make sure that the lid of the soap dispenser is closed before starting the washer.

## 7. Starting the Washer

### Coin Operated (PD) models:

Insert payment needed for operation. The display shows the amount remaining to be paid. If the display shows SELECT CYCLE, the washer can be started.

Add powdered detergents and other wash additives prior to selecting a cycle (see Step 6 above).

Select the desired cycle by pressing the button for that cycle. If you wish to change cycles, you may do so by pressing the desired cycle button during the initial water fill portion of the cycle. If a more expensive wash program is selected, the amount to add will be shown. If the additional amount is not added, the washer will run the original cycle.

### Non-Coin Operated Models:

Add powdered detergents and other wash additives prior to selecting a cycle (see Step 6 above).

Select the desired cycle by pressing the number for that cycle. If you wish to change cycles, you may do so by pressing the desired cycle number during the initial water fill portion of the cycle.

### Full Control (PN) Models:

Add powdered detergents and other wash additives prior to selecting a cycle (see Step 6 above).

Use the keypad to enter the number of the desired cycle. The name of the selected cycle will be displayed. Press the “START” button to start the wash cycle. If no wash cycle is available for the selected program number, INVALID will be displayed. While the washer is running, the display will show the following information:

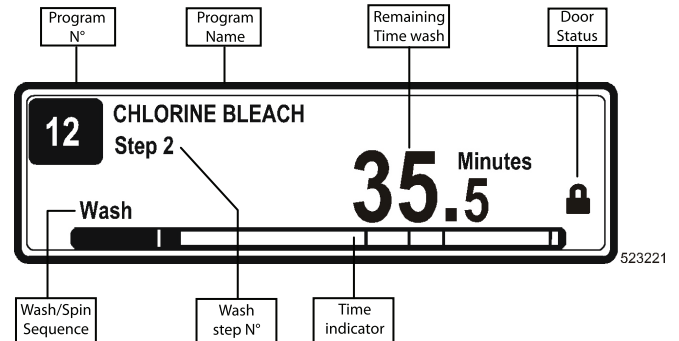

For all models, the washer will not start until the door latches and the desired cycle button or the “START” button is pressed. If the door is not closed, close and latch the door, then press the desired cycle or “START” button again.

During the wash cycle, the cycle progress and estimated time remaining will appear in the display.

## 8. End of Wash Cycle

### PD models:

The end of the cycle is indicated when the display shows “0” minutes remaining. You can open the door when the UNLOCK appears in the display.

### PN models:

The end of the cycle is indicated by “unload” appearing on the display.

To accelerate the wash program, see the “Programming Manual.”

## To Open the Door in an Emergency

**NOTE:** If the door does not open immediately, wait approximately 3 to 5 minutes and try again. This washer features a safety latch and will not unlock until the washer has cooled to a certain temperature.

### If the door will not open after several minutes:

**IMPORTANT:** This procedure should only be done by a qualified servicer.

Make sure that the drum has completely stopped and drained before opening the door. Opening the door while there is still hot water in the drum can cause serious burns. Make sure that the remaining water has cooled down completely before you open the door.

Should the door still fail to open, for example in the event of a power failure, the door can be opened as follows (power must be turned off):

1. Remove the lower service panel located on the front of the washer.
2. A door release cord is located behind the panel on the left hand side. Pull down on the release cord, then open the door.
3. Reinstall the service panel.

## 8. End of Wash Cycle (cont.)

### Models with Tilting Feature:

Some models have the ability to tilt forward up to 15°, allowing easier unloading of the garments.

The washer has a hand-held control that allows the operator to tilt the washer forward and rotate the drum to the left or right, as desired.

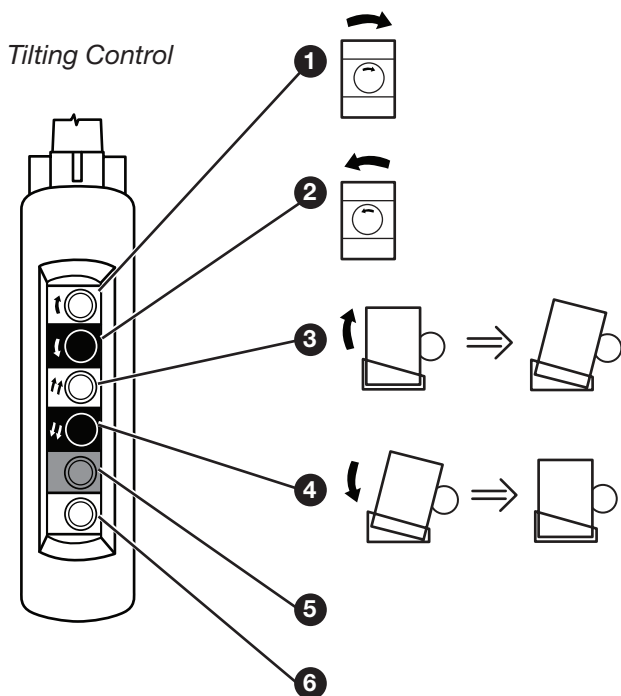

#### Tilting Control Buttons:

- 1 Sets the drum to rotate clockwise.
- 2 Sets the drum to rotate counterclockwise.
- 3 Tilts the washer forward.
- 4 Tilts the washer back to its original position.
- 5 An extra button for additional functions as desired.
- 6 Activates drum rotation.

#### Control Panel

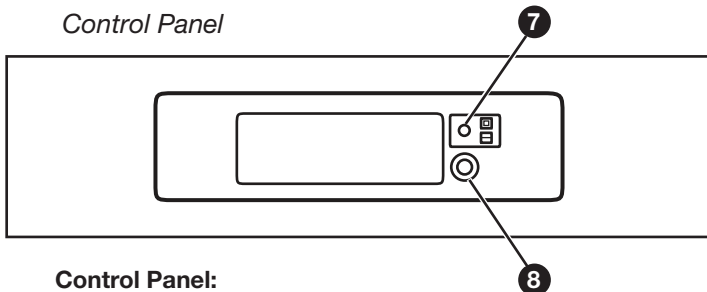

#### Control Panel:

- 7 Key Switch
- 8 Emergency Stop Button

#### To Use the Tilting Feature:

1. Open the door until the Door Tilt Latch secures the door in the open position.

**NOTE:** The Tilting Feature can only be used when the door is open. Also, the Key Switch must not be in programming mode.

2. Tilt the washer forward by pressing and holding button 3. When the washer reaches the tilt position you want, release the button. (Once the degree of tilt reaches 15°, the tilting will stop automatically.)
3. Set the direction in which you want to rotate the drum by pressing button 1 or 2.

**NOTE:** Never reach into a washer or grab clothes while the drum is rotating. Let gravity and the rotation movement empty the washer.

4. Start the drum rotation by pressing button 6.
5. To change the tilt position backward or forward, press button 4 or 3. Release the button when it reaches the desired position.
6. After unloading items, press button 4 until washer returns to original position. Release button and close the door. To run a new cycle, the washer must be back in its original, untilted position.

**NOTE:** The door must remain open when washer is being tilted back to its original position. If not, a message will appear on the display.

## SET-UP PROCEDURES

### Washer-related set-up

Adjust washer-related settings in the configuration menu.

### Cycle-related set-up

Adjust cycle-related settings in the initialization menu.

### PD models:

Price settings can be adjusted in the price menu.

These adjustments must be made by authorized personnel.

For set-up instructions, see the "Programming Manual."

## MAINTENANCE

### DAILY MAINTENANCE

- Keep the washer clean at all times. Do not allow residual soap and any cleaners to remain on the washer cabinet or top for any length of time.
- Clean the detergent dispenser at the end of each business day as follows:
  - a. Detergent may be stuck to the detergent box liner. This can be scraped loose by using a spatula.
  - b. Flush the loosened detergent with warm water.
- Check the drain valve daily to make sure it is not leaking during operation. Also make sure the valve is opening properly.
- Clean the door lip seal of any remaining detergent or foreign matter.
- Clean door glass of any accumulated debris.
- Once the washer has been properly cleaned, open the door and the detergent dispenser to allow for air drying. Leave doors open at night.
- At the end of each business day, it is recommended that you disconnect the "main" water and electrical power source to the washer(s). It is not necessary to shut off the water and power to each individual washer.
- Check door lock functions.

Reinstall all panels and reestablish all safety guards after maintenance.